

QM896741

ELBOW OPERATED SOAP DISPENSER

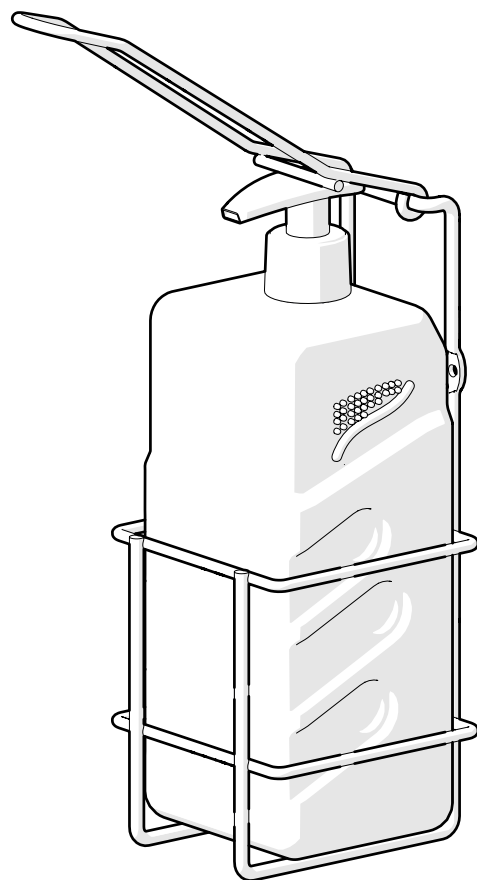

CONTACT DETAILS

Croydex
Central Way
Andover
Hampshire
SP10 5AW
UK

Tel: +44 (0)1264 365881
Email: info@croydex.co.uk

www.croydex.com

**ALL PRODUCT DIMENSIONS DETAILED IN
THIS INSTALLATION AND MAINTENANCE
MANUAL ARE APPROXIMATE**

**ALL ILLUSTRATIONS OF THE PRODUCT ARE
FOR REFERENCE ONLY. COMPONENTS
SUPPLIED WITH INDIVIDUAL PRODUCTS
MAY DIFFER**

SECTION 1 - INTRODUCTION

INTRODUCTION

Please follow all assembly and product care instructions to ensure that your product is assembled safely and retains its high quality finish.

**PLEASE RETAIN THIS MANUAL FOR
FUTURE REFERENCE**

PRODUCT FITTING

IMPORTANT!

Before attempting to fit or use this product. Ensure that it can be properly installed in the location you wish it to be in.

SECTION 1 - INTRODUCTION

SAFETY & PRODUCT CARE

1. **ALWAYS** take care when using power tools, particularly if there is any water in the working area.
2. **ALWAYS** wear eye protection when using power tools.
3. **ALWAYS** check for pipes and cables before drilling into walls.
4. **NEVER** use a hammer drill when drilling into tiled surfaces.
5. **ALWAYS** use a drill bit that is suitable for the surface that is being drilled.
6. The wall plugs supplied are for use on solid walls only. For cavity walls or plasterboard **ALWAYS** use specialist fixings that are suitable for the type of wall construction.
7. **DO NOT** use abrasive or chemical cleaners as these may damage the product.

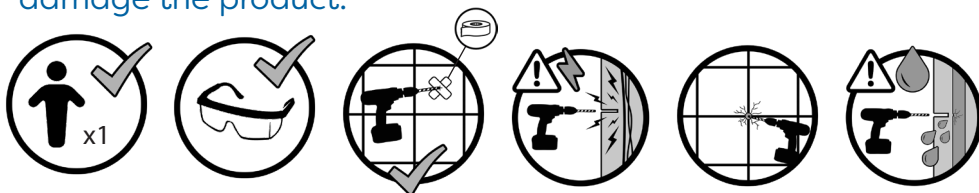

WALL FIXING PACK

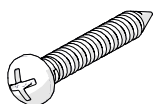

x2 wall
screws

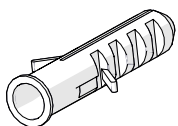

x2 wall
plugs

TOOLS REQUIRED

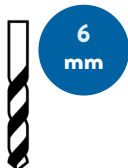

SECTION 2 - INSTALLATION

1. Place the dispenser cage in the desired location and mark the positions of the mounting holes. Drill 6mm holes in the marked positions and insert two wall plugs. Then, fix the dispenser cage to the wall using the supplied screws.

(See Fig. 1)

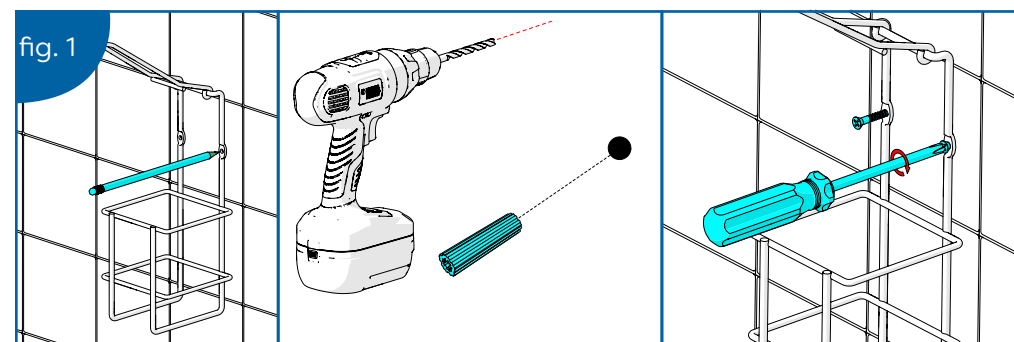

2. Fill the dispenser with a **MAXIMUM** of 1 Litre of your desired liquid. The bottle **MUST** be inserted into the dispenser cage in the correct orientation as shown below. Before use ensure the lock is turned fully clockwise towards 'open'.

(See Fig. 2)

